

PARTS BAG UPC 8083 3' 11 Tier Inline Base Kit

| PART | Quantity | Reference |
|--------------------------|--------------|-----------|
| Connector Bolt | 12 | A |
| Nut | 4 | B |
| 3/8" Trusshead Screw | 4 | C |
| 3/4" Wood Screw | 16 | D |
| Push Pins | 25 (3 extra) | E |
| Key | 2 | F |
| Leveler | 4 | G |
| Left Bracket | 1 | H |
| Right Bracket | 1 | I |
| Connector Nut | 2 | J |
| Connector Bolt - Machine | 2 | K |
| Hex Wrench | 1 | L |
| Bolt Cap | 4 | W |

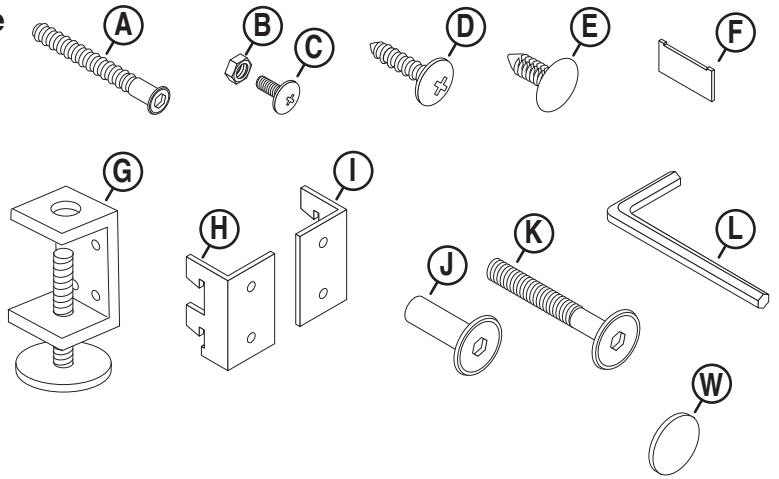

OTHER TOOLS REQUIRED: #2 Phillips & Flatblade Screwdriver

PARTS

| PART | Quantity | Reference |
|------------------|----------|-----------|
| Side Panel | 2 | M |
| Lower Rear Panel | 1 | N |
| Upper Rear Panel | 1 | O |
| Front Panel | 1 | P |
| Clear Rack | 1 | Q |
| White Rack | 10 | R |
| Slotted Upright | 2 | S |
| Sign Track | 1 | T |
| 3 Tier Divider | 12 | U |
| 5 Tier Divider | 6 | V |

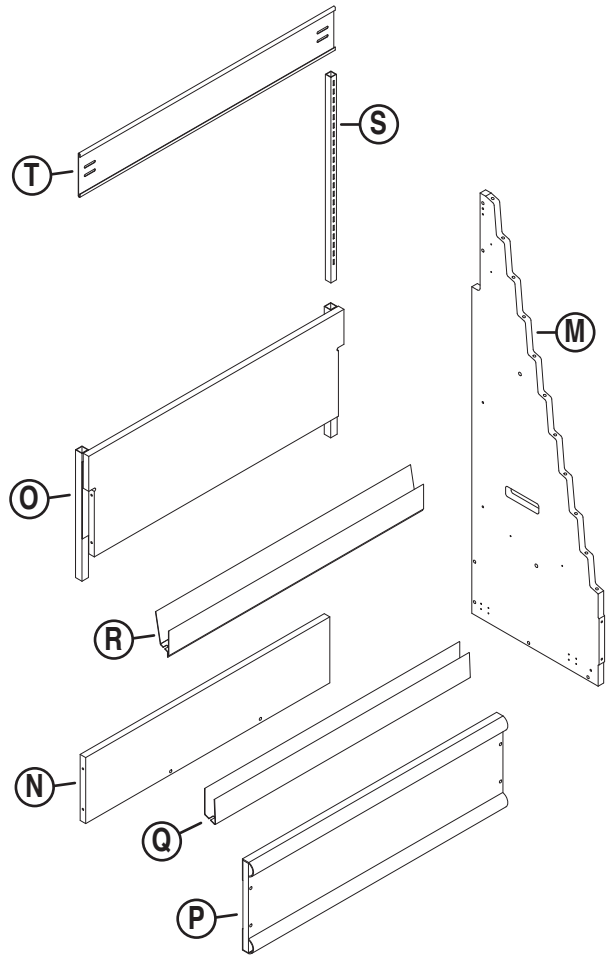
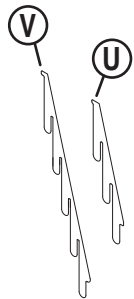
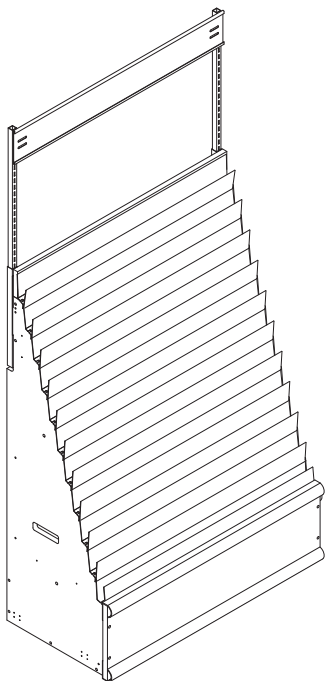

If you have any questions or need replacement parts, please call:
UPC Customer Service
 1-800-859-7442
Design & Manufacture

If you have any questions or need replacement parts, please call:

UPC Customer Service
1-800-859-7442

Design & Manufacture

ASSEMBLY

- 1 Attach (4) **Levelers (G)** to “inside” faces of (2) **Side Panels (M)**, using (16) **3/4” Wood Screws (D)**.

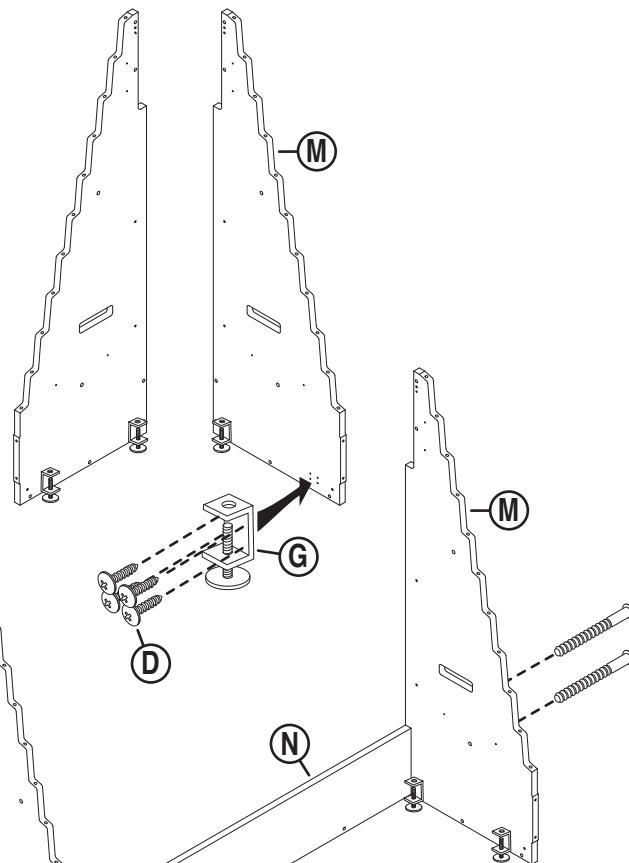

- 2 Use (4) **Connector Bolts (A)** to attach **Lower Rear Panel (N)** in between (2) **Side Panels (M)**.

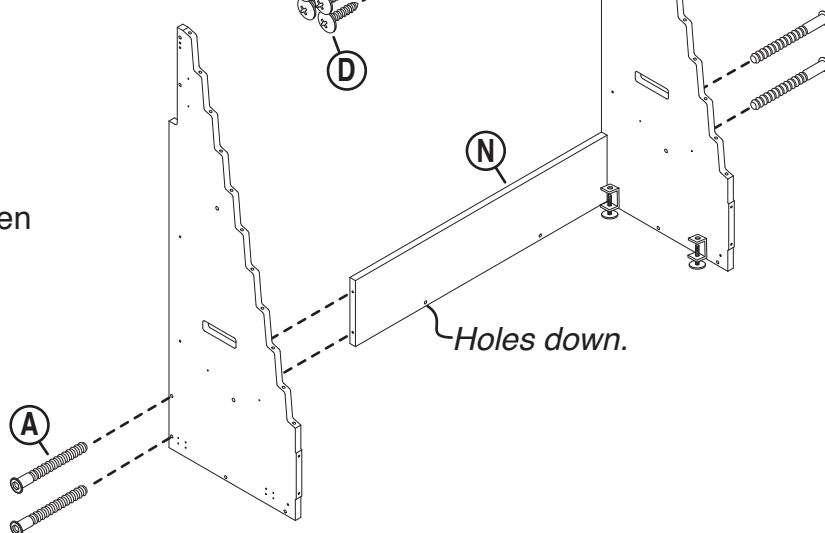

- 3 Use (4) **Connector Bolts (A)** to attach **Upper Rear Panel (O)** in between (2) **Side Panels (M)**.

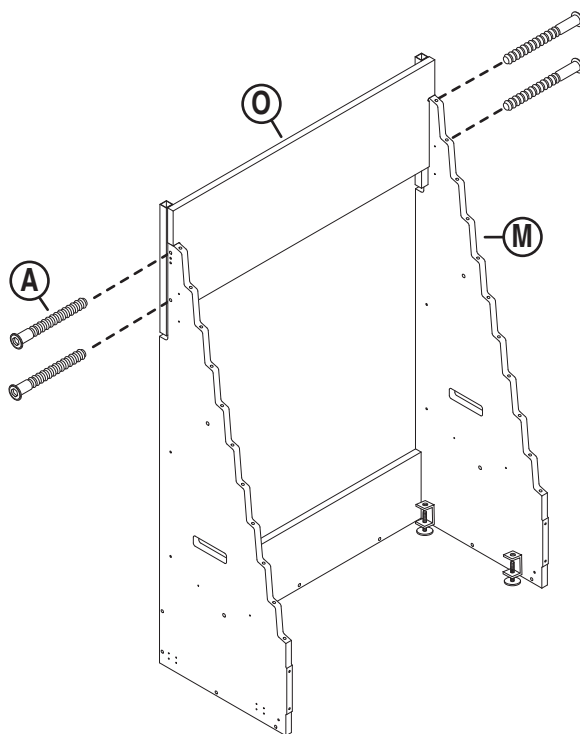

If you have any questions or need replacement parts, please call:

UPC Customer Service
1-800-859-7442

Design & Manufacture

ASSEMBLY

- 4 Attach **Front Panel (P)** to assembly using (4) **Connector Bolts (A)**. After tightening **Connector Bolts (A)**, cover with (4) **Bolt Covers (W)**.

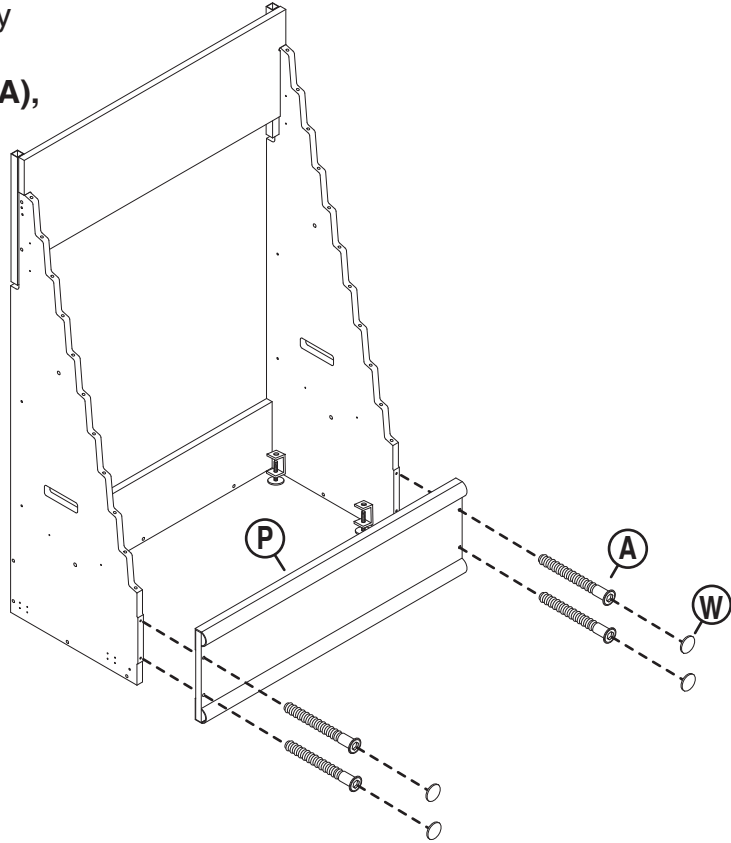

- 5 Position and level the assembly.

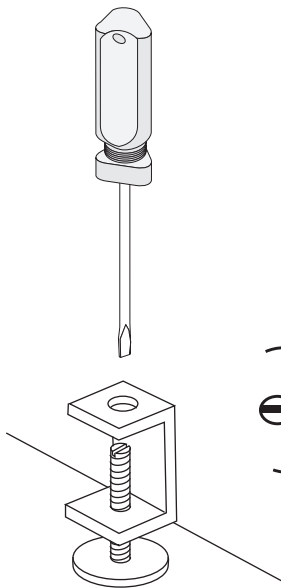

NOTE:

• All points should be at least $\frac{1}{4}$ " above the floor.

*By turning clockwise,
you will raise the fixture.*

*By turning counter-clockwise,
you will lower the fixture.*

If you have any questions or need replacement parts, please call:

UPC Customer Service
1-800-859-7442

Design & Manufacture

ASSEMBLY

NOTE:

**IF NOT BOLTING TWO FIXTURES TOGETHER,
MOVE AHEAD TO STEP 7.**

6 SIDE BY SIDE:

Attach two fixtures together using (2)
Connector Bolts - Machine (K) and (2)
Connector Nuts (J) as shown here.

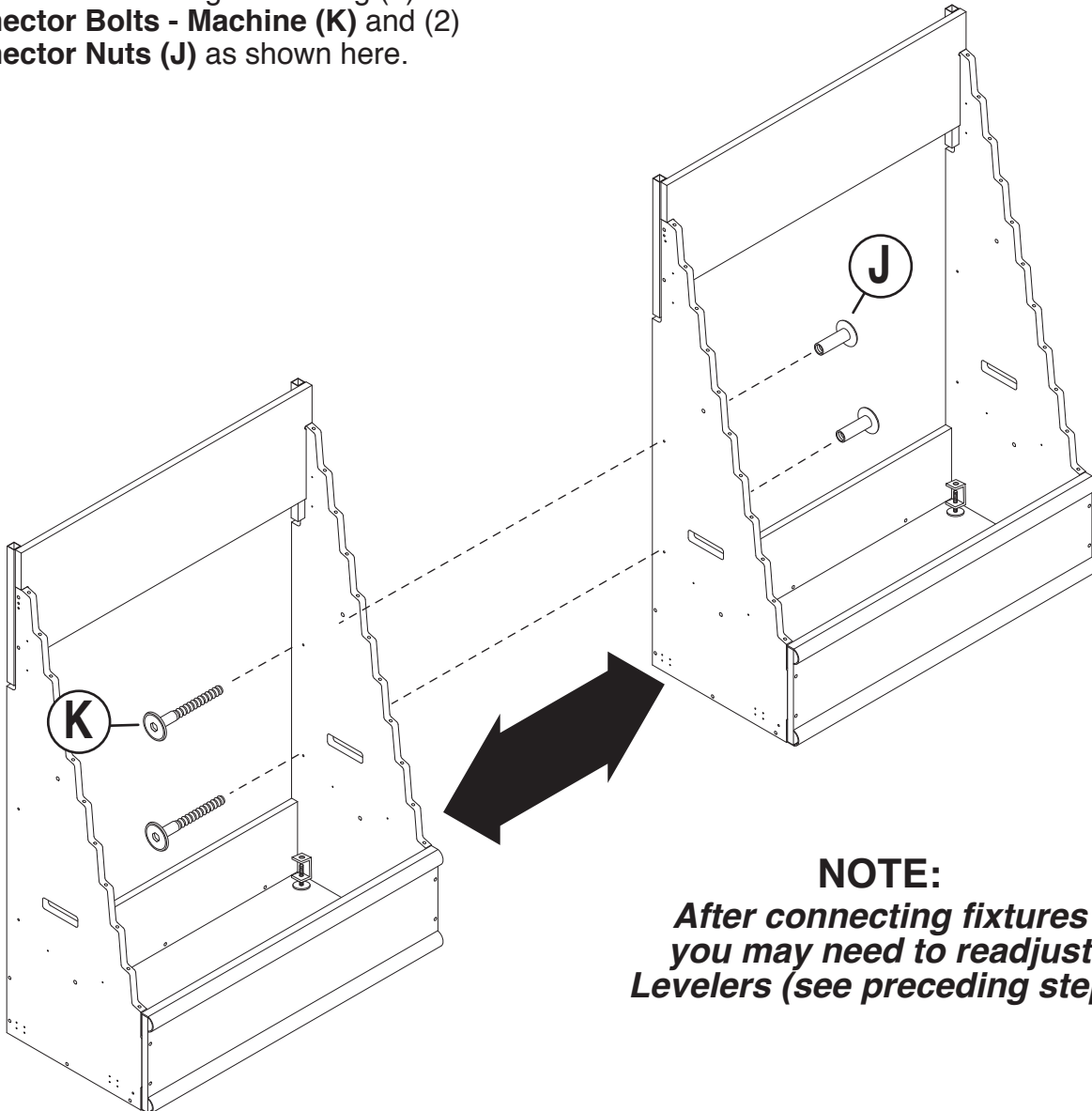

NOTE:

**After connecting fixtures
you may need to readjust
Levelers (see preceding step.)**

If you have any questions or need replacement parts, please call:

UPC Customer Service
1-800-859-7442

Design & Manufacture

ASSEMBLY

- 7** Peel off the masking and install the **Clear Rack (Q)** on the bottom using (2) **Push Pins (E)**.

See Push Pin installation tip below right.

Install (10) **White Racks (R)** using (20) **Push Pins (E)**, working from lowest up.

See Rack installation note below left.

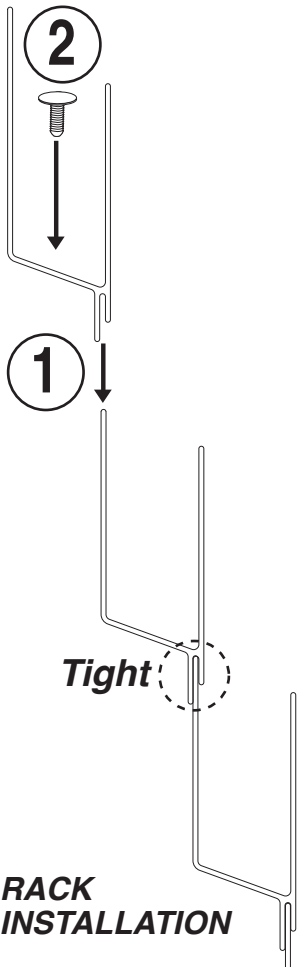
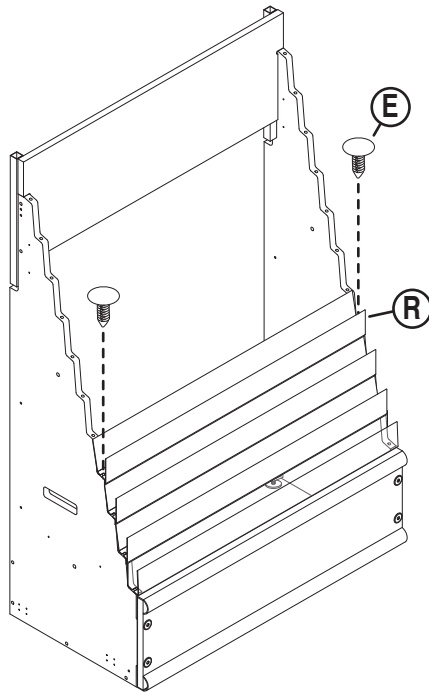
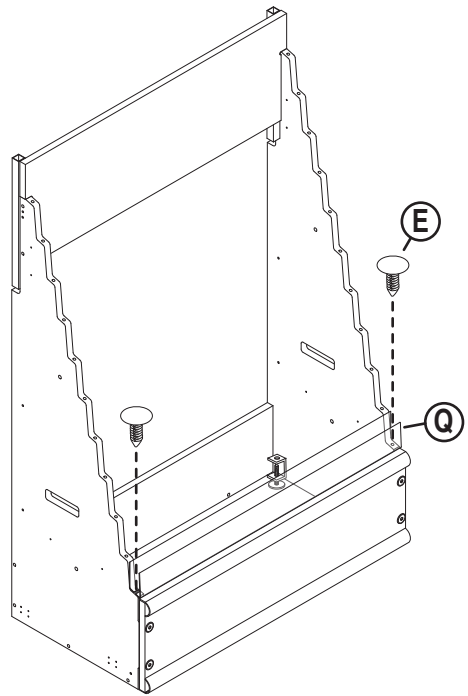

TIP: Many installers gently bend the rack open (below) and use the end of a screwdriver handle or hammer handle to press **Push Pins (E)** firmly into place.

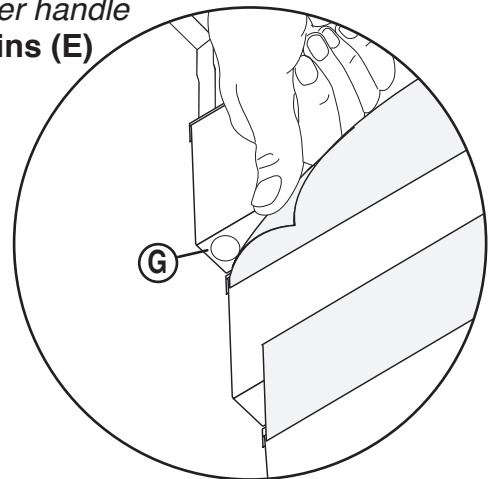

If you have any questions or need replacement parts, please call:

UPC Customer Service
1-800-859-7442

Design & Manufacture

ASSEMBLY

- 8** Insert (2) **Slotted Uprights (S)** in square holes in top of assembly and secure at desired height using (2) **Keys (F)** with indentations up.

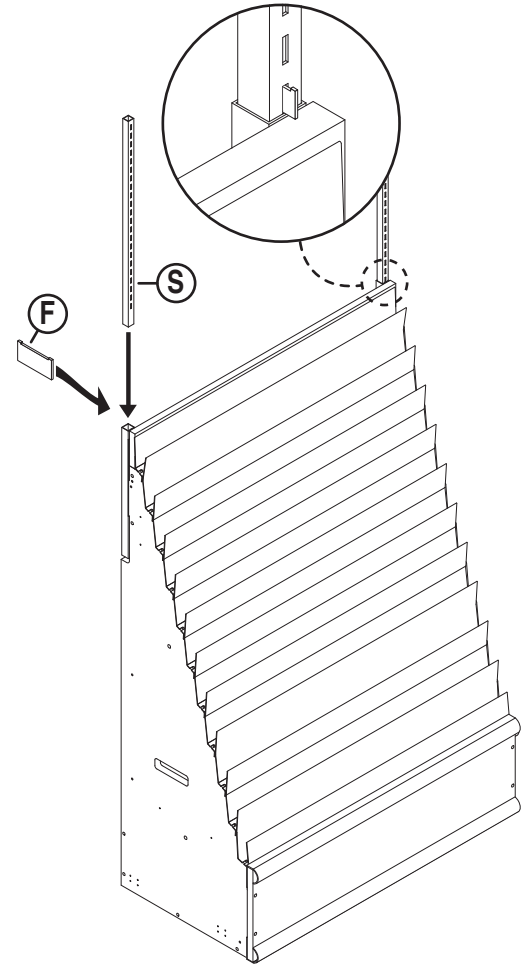

- 9** Attach **Left & Right Brackets (H&I)** to back of **Sign Track (T)** using (4) **Nuts (B)** and (4) **3/8" Trusshead Screws (C)**.
Be sure Bracket slots open down.
Hook **Sign Track Assembly** onto display.

NOTE: If using optional Extender 8080 do not attach Brackets, see instructions with Extender.

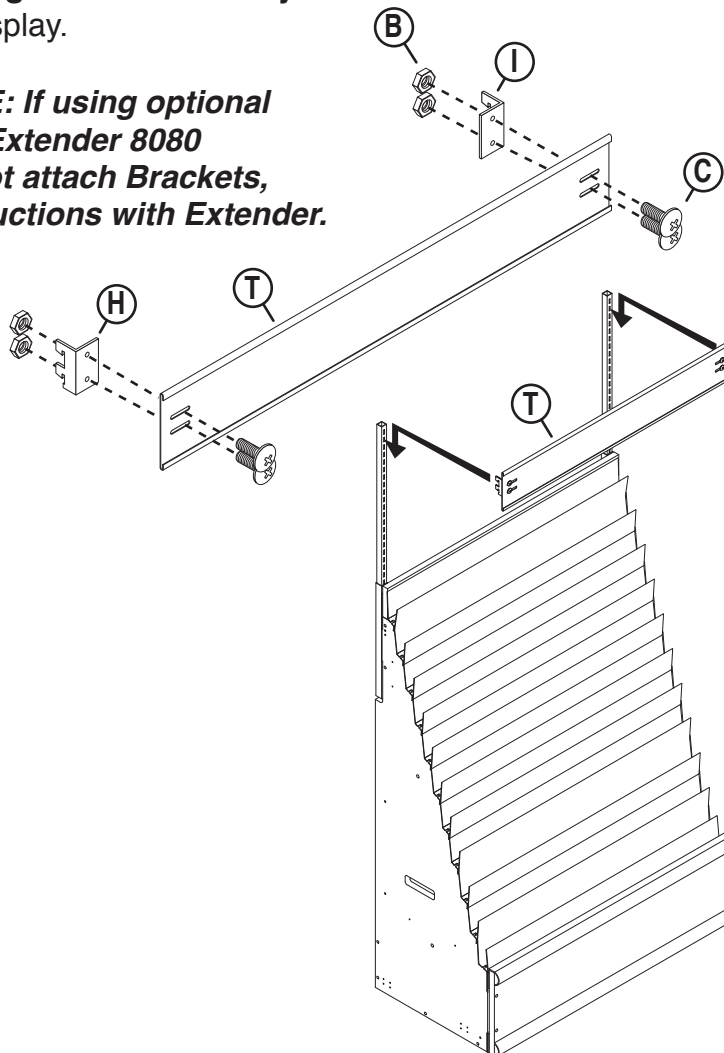

If you have any questions or need replacement parts, please call:
UPC Customer Service
1-800-859-7442

Design & Manufacture

ASSEMBLY

- 10** Install (6) **5-Tier Divider Strips (V)** in bottom 5 racks.
Install (12) **3-Tier Divider Strips (U)** in the top 6 racks.

