

# ASSEMBLY INSTRUCTIONS

## PARTS BAG

UPC 3535

5.5" up to 48" wide with 2/3 Exposure 2-Tier PETG Rack

PART	Quantity	Reference
Screw Post	2-3	A
Slatwall Adapters	2-3	B
Nuts	2-3	C
Plastic Wall Toggler	2-3	D
Philips Head Screws	2-3	E
Card Clips	2-16	F

**NOTE:** Quantities of parts vary with width of Rack chosen.

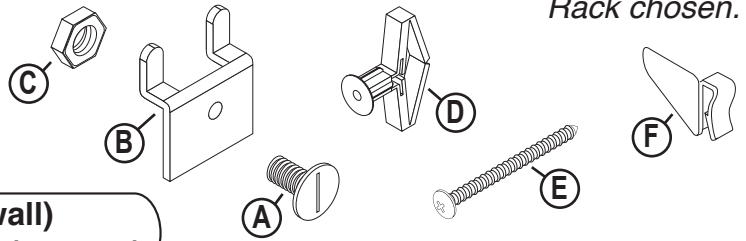

**TOOLS REQUIRED:** Flathead Screwdriver (Slatwall)  
Drill with 3/8" Drywall Bit & Phillips Screwdriver (Drywall)

## PARTS LIST

PART	Quantity	Reference
Rack	1	G

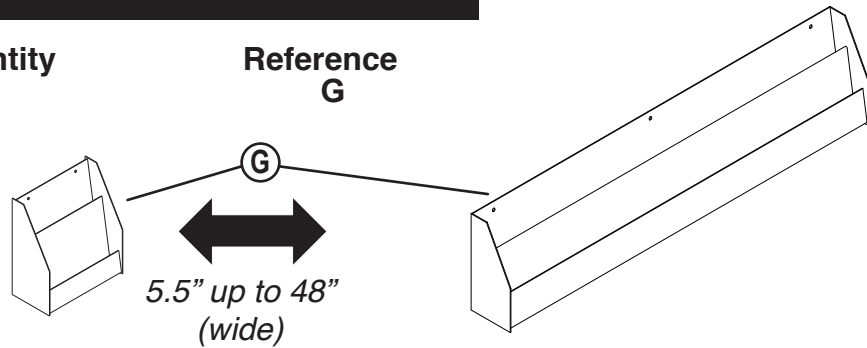

## Slatwall Assembly

**NOTE:** Assemble for EITHER Slatwall or Drywall, not both.

- Align hole in **Slatwall Adapter (B)** with back side of hole in **Rack (G)**. Prongs extend back toward Slatwall and up. Attach using **Screw Post (A)** from front and **Nut (C)** on back.

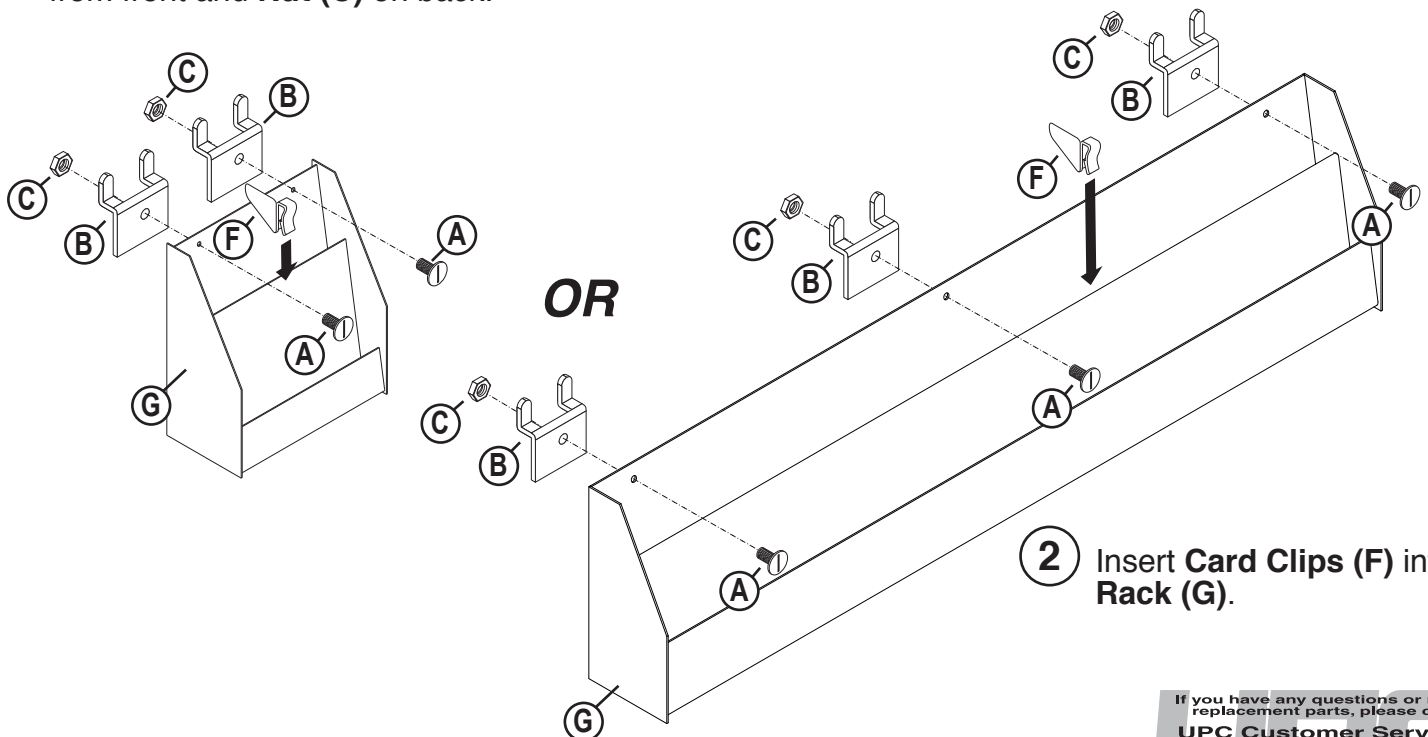

- Insert **Card Clips (F)** into **Rack (G)**.

If you have any questions or need replacement parts, please call:  
**UPC Customer Service**  
1-800-859-7442

**Design & Manufacture**

# Drywall Assembly

**NOTE:** Assemble for EITHER Slatwall or Drywall, not both.

- ① Determine position on wall and drill hole with 3/8" drywall bit. Squeeze **Wall Toggler (D)** flat and insert into hole. Tap flange flush with wall.

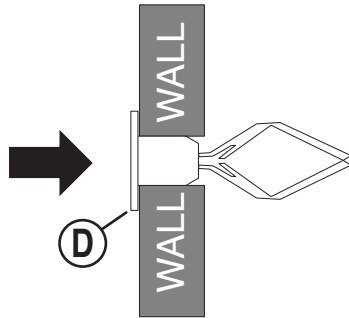

- ② Place **Rack (G)** against **Wall Toggler (D)** and insert **Phillips Head Screw (E)**, tightening until secure.

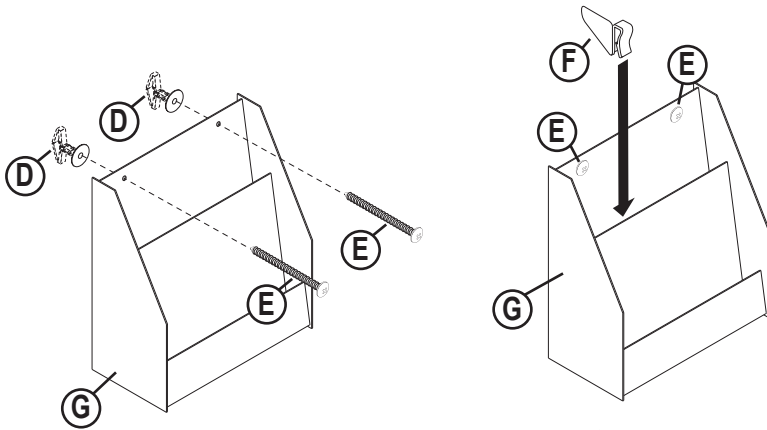
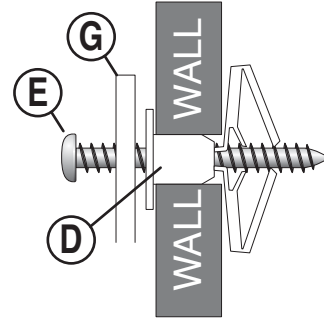

- ③ Insert **Card Clips (F)** into **Rack (G)**.

**OR**

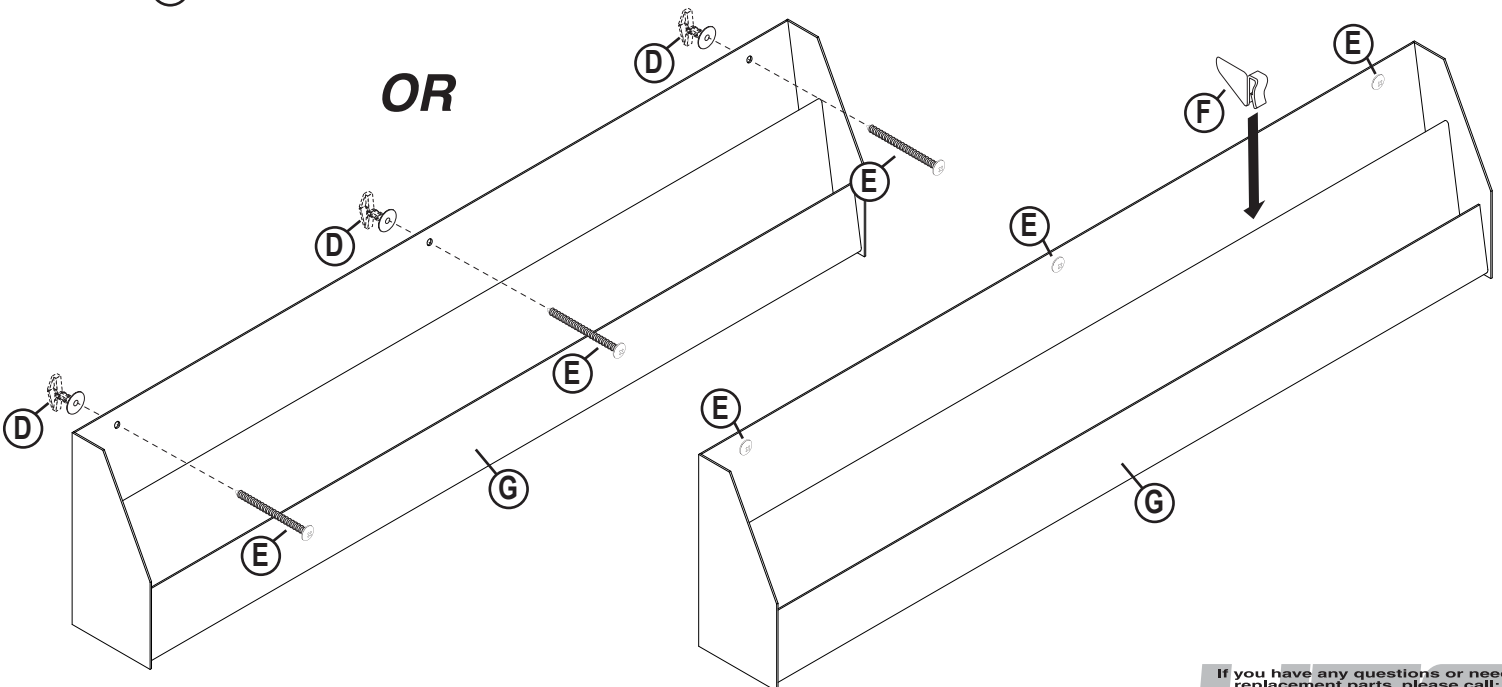

If you have any questions or need replacement parts, please call:  
**UPC Customer Service**  
1-800-859-7442

**Design & Manufacture**