

# ASSEMBLY INSTRUCTIONS

## PARTS BAG UPC 2012 5.5" up to 48" Wide 4-Tier PETG Card Rack

PART	Quantity	Reference
Screw Posts	2-3	A
Slatwall Adapters	2-3	B
Nuts	2-3	C
Plastic Wall Toggles	2-3	D
Phillips Head Screws	2-3	E

**NOTE:** Quantities of parts vary with width of Rack chosen.

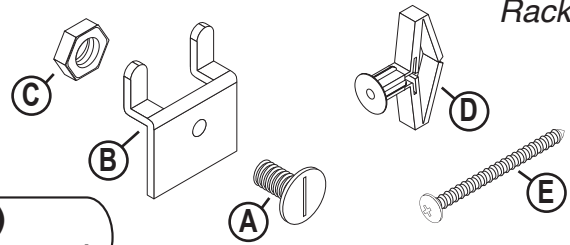

**TOOLS REQUIRED:** Flathead Screwdriver (Slatwall)  
Drill with 3/8" Drywall Bit & Phillips Screwdriver (Drywall)

## PARTS LIST

PART	Quantity	Reference
Divider	1-8	F
Rack	1	G

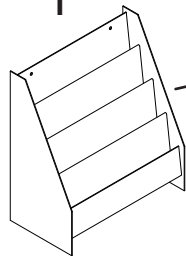
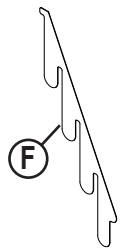

5.5" up to 48"  
(wide)

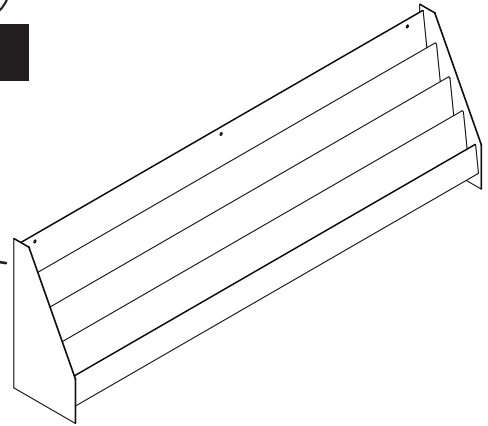

## Slatwall Assembly **NOTE:** Assemble for EITHER Slatwall or Drywall, not both.

- Align hole in **Slatwall Adapter (B)** with back side of hole in **Rack (G)**. Prongs extend back toward Slatwall and up. Attach using **Screw Post (a)** from front and **Nut (C)** on back.

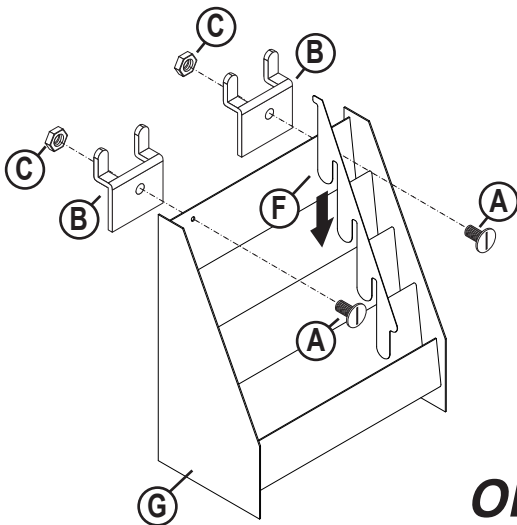

OR

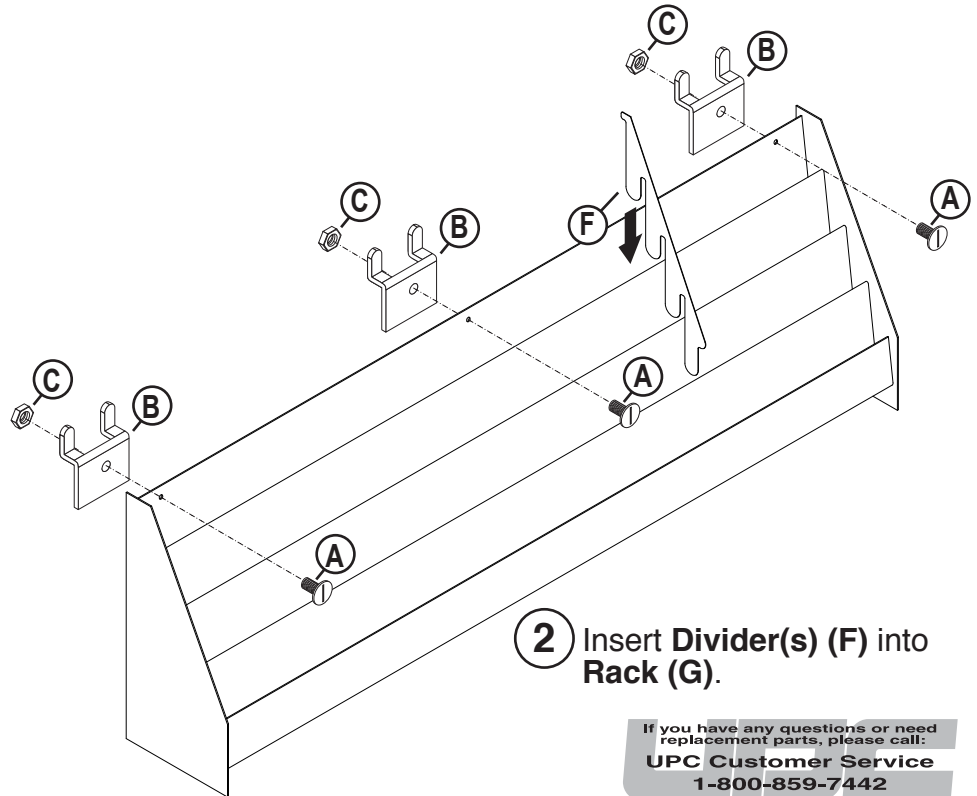

- Insert **Divider(s) (F)** into **Rack (G)**.

If you have any questions or need replacement parts, please call:  
**UPC Customer Service**  
1-800-859-7442

**Design & Manufacture**

# Drywall Assembly

**NOTE:** Assemble for EITHER Slatwall or Drywall, not both.

- 1 Determine position on wall and drill hole with 3/8" drywall bit.  
**Squeeze Wall Toggler (D)** flat and insert into hole.  
Tap flange flush with wall.

- 2 Place **Rack (G)** against **Wall Toggler (D)** and insert **Phillips Head Screw (E)**, tightening until secure.

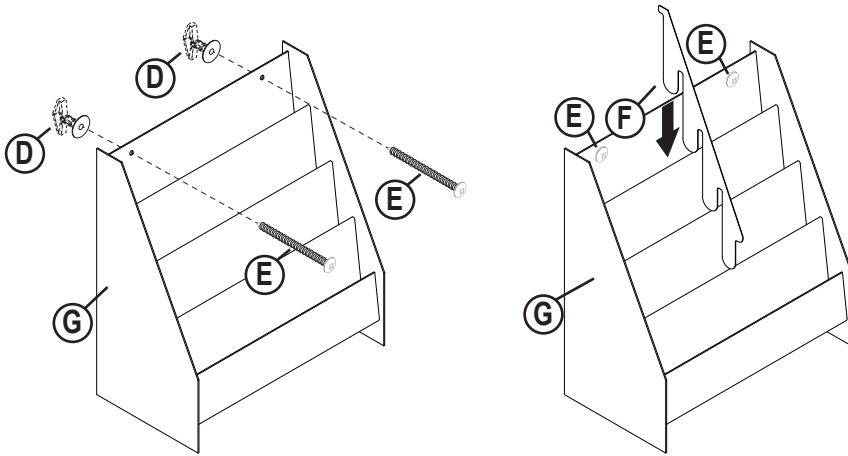
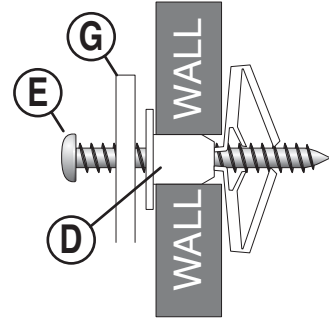
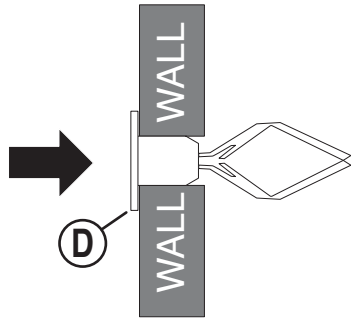

- 3 Insert **Divider(s) (F)** into **Rack (G)**.

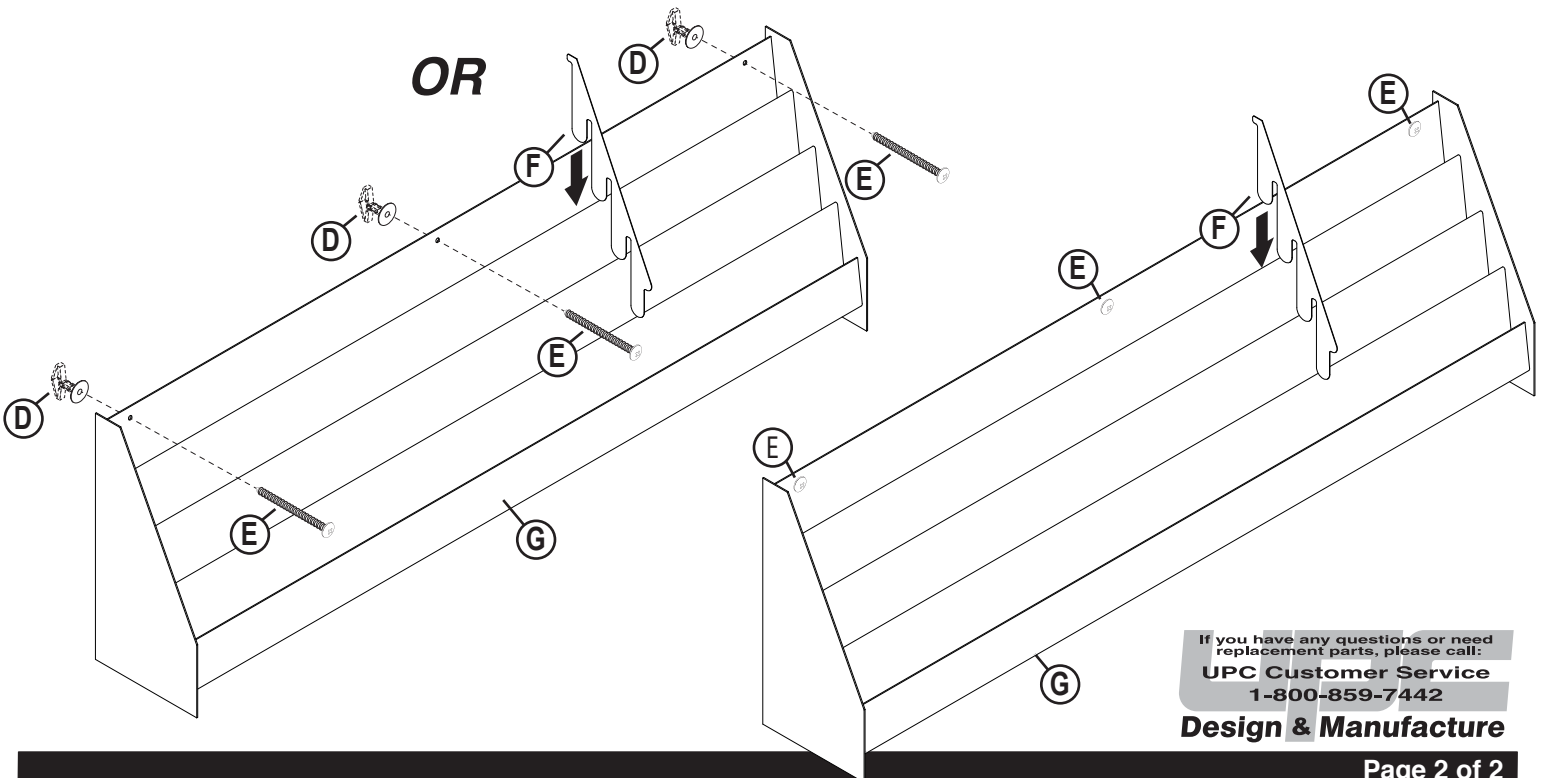

If you have any questions or need replacement parts, please call:  
**UPC Customer Service**  
1-800-859-7442

**Design & Manufacture**