

PARTS BAG

UPC 14532

Caster Kit for Icon Spinner

PART	QTY.	Reference
Phillips Head Screws	4	A
Locking Casters	4	B

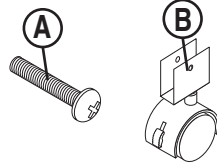

TOOLS REQUIRED: #2 Phillips Screwdriver

Caster Instructions

NOTE: That caster has a large hole and a small threaded hole. Screw should be inserted through the large hole and then into the small threaded hole and tightened.

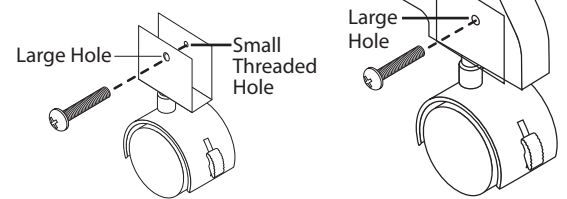

ASSEMBLY

- 1 If **Tack Glides** interfere with casters, remove (4) nail on **Tack Glides** from bottom of Base Assembly prior to installation of casters.

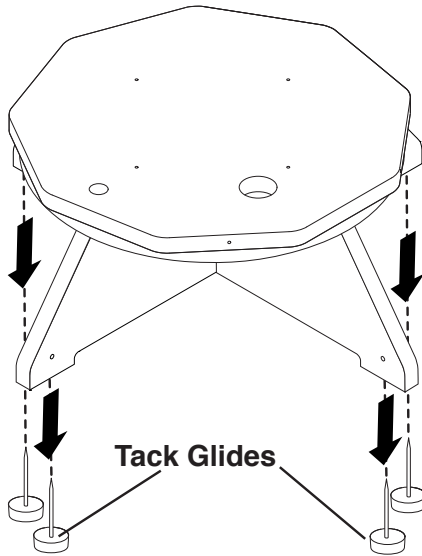

- 2 Align & position (4) **Locking Casters (B)** to holes in Base Assembly. As shown below.

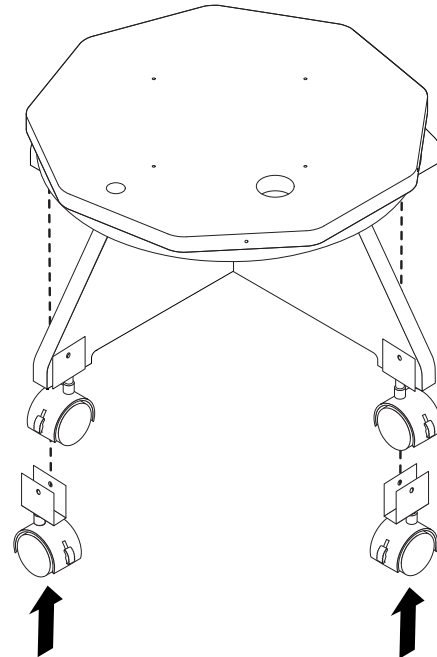

- 3 Screw **Phillips Head Screws (A)** through **Locking Casters (B)** into Base Assembly.

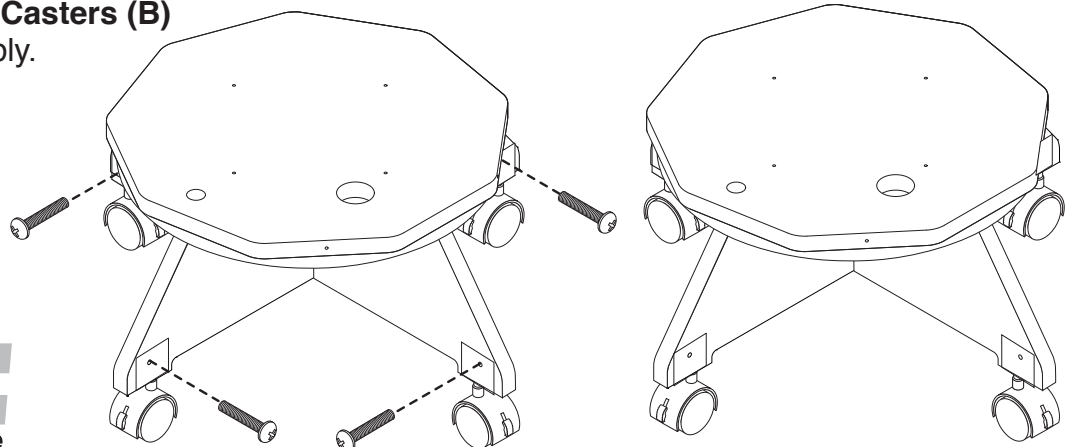

If you have any questions or need replacement parts, please call:

UPC Customer Service
1-800-859-7442

Design & Manufacture