

ASSEMBLY INSTRUCTIONS

Thank you for your purchase of one of many fine products designed & manufactured by UPC. We have made every effort to make your assembly easy, clear & hassle free. For more information or if you have any questions contact customer service at 1-800-859-7442.

PARTS BAG UPC 12436 48 Pocket Icon Letterpress Spinner

PART	Quantity	Reference
Push Pins	9 (1 extra)	A
Trusshead Screws	4	B
Connector Bolts	4	C
Short Trusshead Screws	4	D
Hex Wrench	1	E
Header Clip	1	F

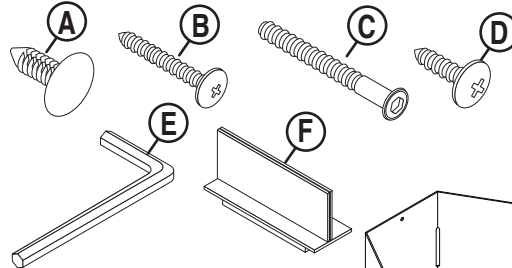

TOOLS REQUIRED: #2 Phillips Screwdriver

PARTS LIST

PART	Quantity	Reference
Top Cap	1	G
Tower Panels	2	H
Spinner Plate	1	I
Top plate	1	J
X-Base Upper	1	K
X-Base Lower	1	L
Racks	48	M
Tower Helpers	3	N

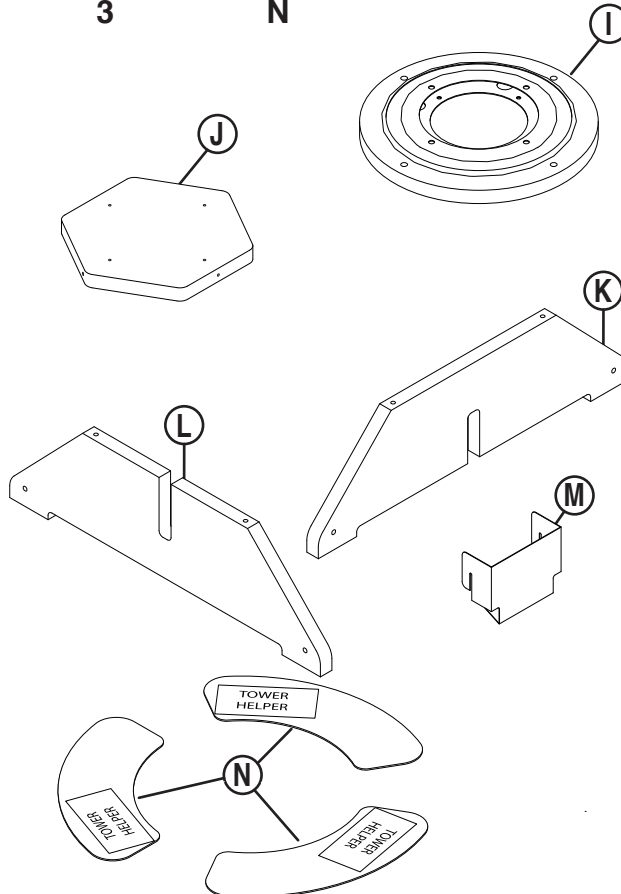
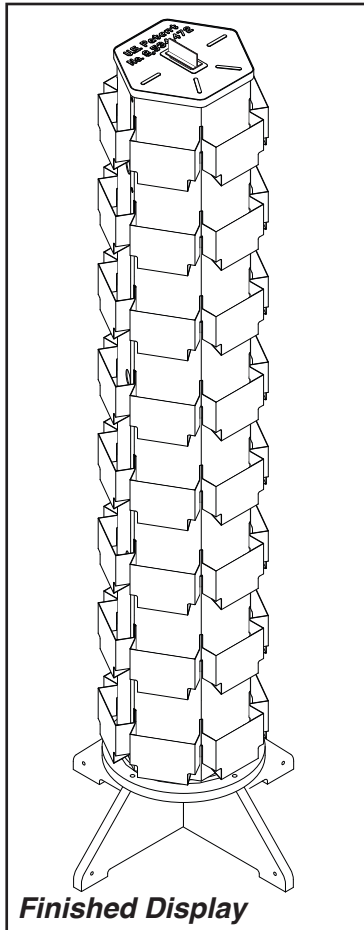
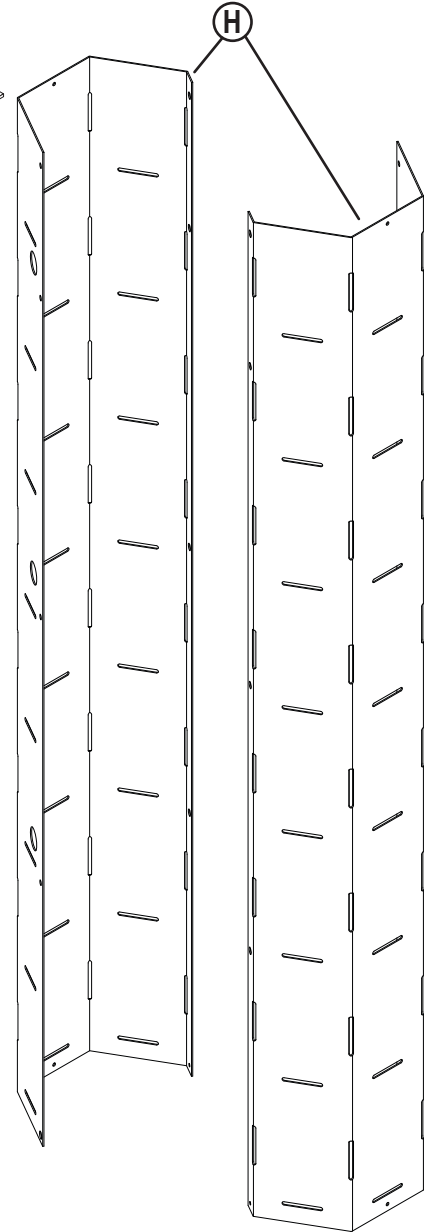
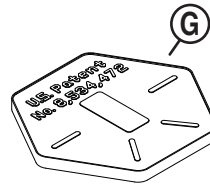

Finished Display

Revised 09/19/16

**U.S. PATENT NO.
8,534,472**

If you have any questions please call:
UPC Customer Service
1-800-859-7442
Design & Manufacture
upcdisplays.com

ASSEMBLY

- 1 Spin and align the largest holes in **Spinner Plate** with **Spinner**.

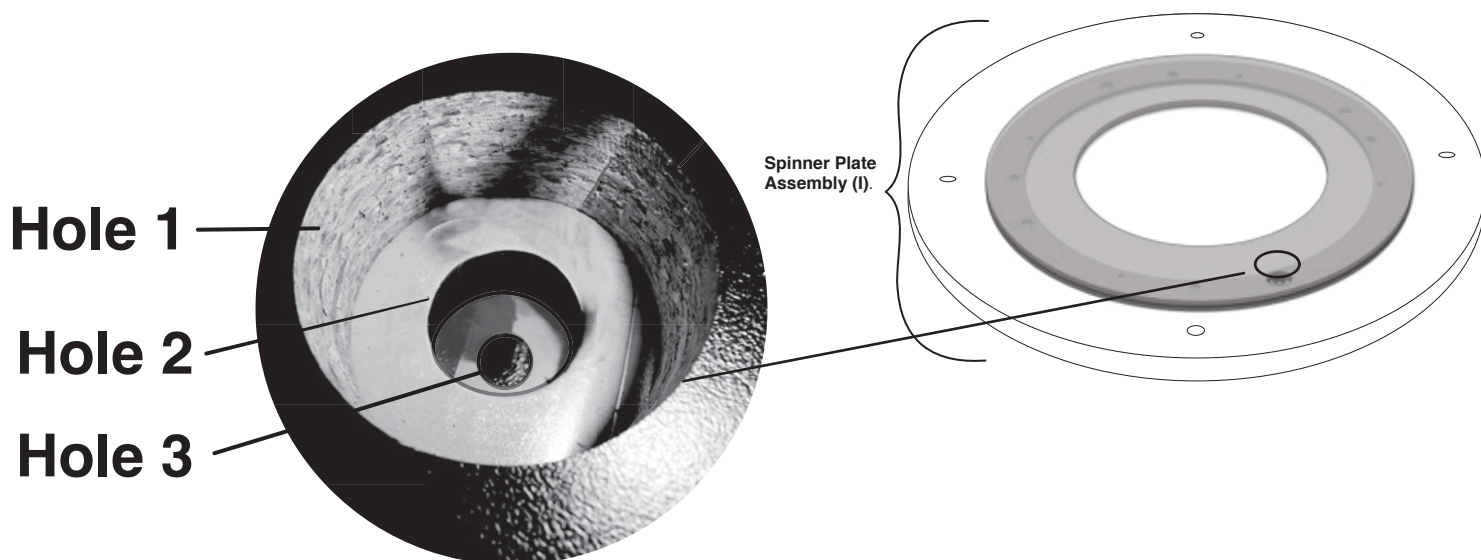

- 2 Align largest screw holes on **Spinner Plate (I)** with one of the four corresponding holes on the **Top Plate (J)**.



ASSEMBLY

- 3** Attach **Spinner Plate (I)** to **Top Plate (J)** by using (1) **Short Trusshead Screw (D)** through large screw hole in **Spinner Plate (I)** to hole in **Top Plate (J)**. **DO NOT** tighten completely!

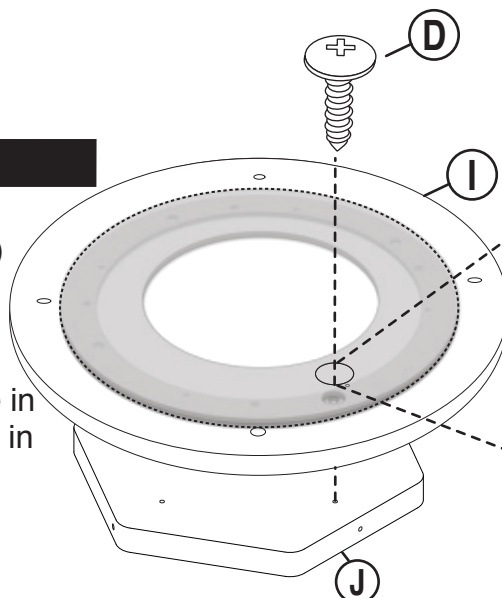

- 4** Turn **Spinner Plate (I)** 90° to continue attachment to **Top Plate (J)**, slight positioning adjustment may be necessary to find hole. To attach **Spinner Plate (I)**, use 2nd **Short Trusshead Screw (D)** through large hole to corresponding hole of **Top Plate (J)**.

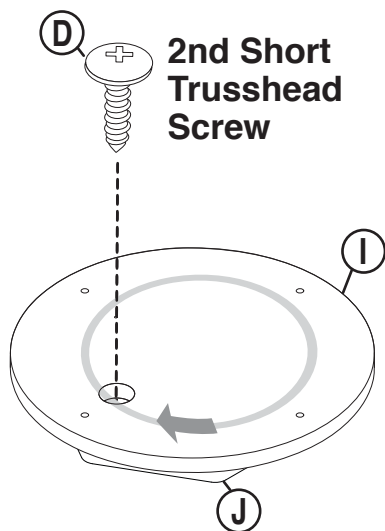

- 5** Repeat Step 3 for attaching **Spinner Plate (I)** to **Top Plate (J)** using 3rd & 4th **Short Trusshead Screws (D)**. Tighten all screws

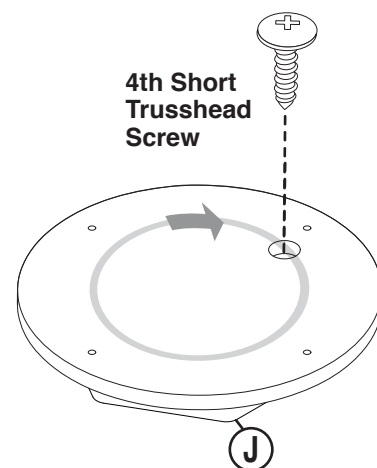
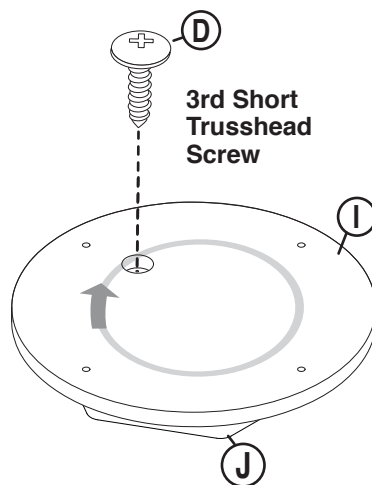

ASSEMBLY

- 6** Insert **X-Base Upper (K)**
into **X-Base Lower (L)**
as shown below.

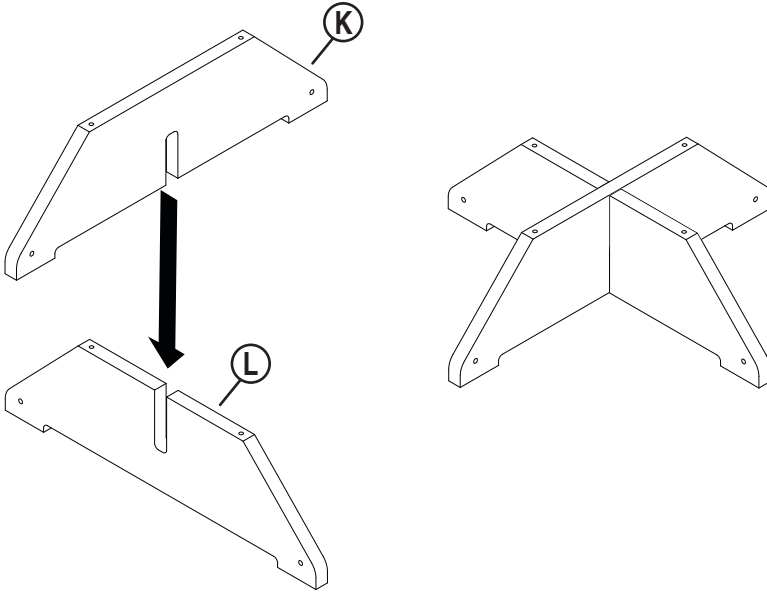

- 7** Attach **Spinner Plate Assembly (I/J)**
to **X-Base Assembly (K/L)**
using (4) **Connector Bolts (C)**.

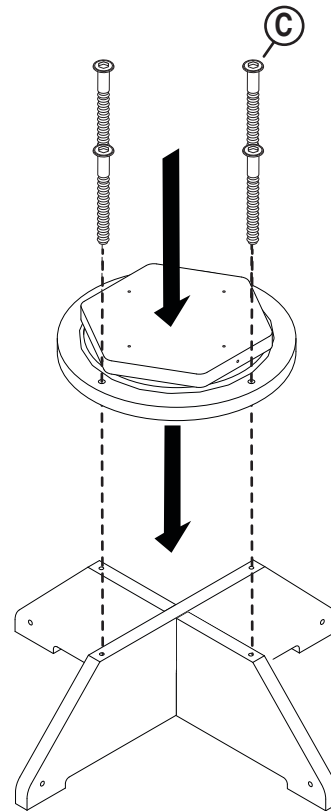

STOP!

STOP! If you are installing casters, please refer to instruction sheet #14532 enclosed in your caster kit.

ASSEMBLY

- 8** A. Peel protective masking off **Tower Panels (H)** before assembly.
- B. Overlap each **Tower Panel (H)** so the large hole of facet lies outside the small hole of adjacent panel. (see figure ABOVE)
- C. Use Large Finger Holes (see figure RIGHT) to hold **Tower Panels (H)** tightly together while installing **Push Pins (A)**.
- D. Join (2) **Tower Panels (H)** together using (8) **Push Pins (A)**. (see figure BELOW)

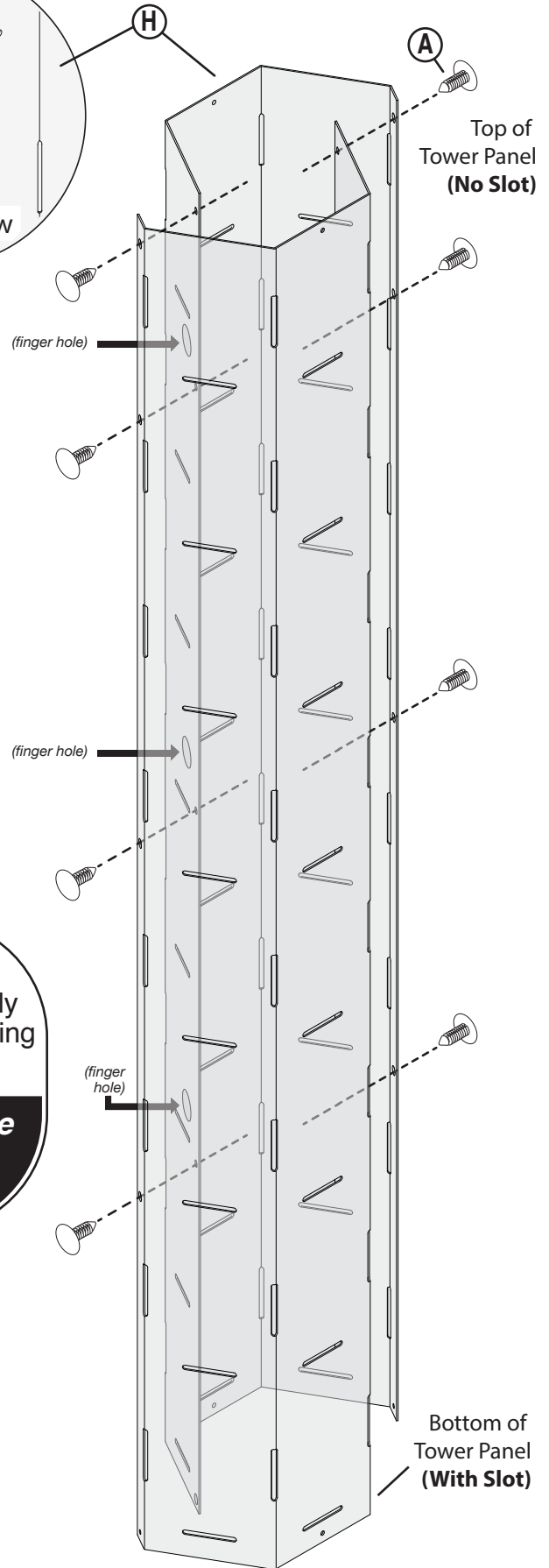
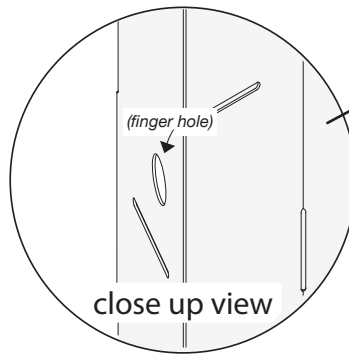

NOTE:

Tower Panels (H) MUST be aligned properly at facets BEFORE securing with **Push Pins (A)**.

Push Pins CANNOT be removed once inserted into holes!

Small Hole
(align behind Large Hole)

Facet with Large Hole
(align in front of Small Hole)

ASSEMBLY

- 9** This step will support **Tower Panel Assembly (H)** up for installation to Base Assembly. Insert (3) **Tower Helpers (N)** in-between **Spinner Plate Assembly (I/J)** and **X-Base Assembly (K/L)** as shown below.

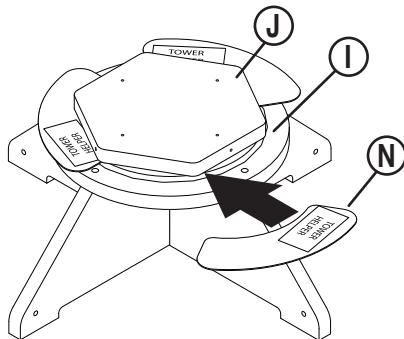

- 10** Align corresponding holes and set the **Tower Panel Assembly (H)** onto the Base Assembly.

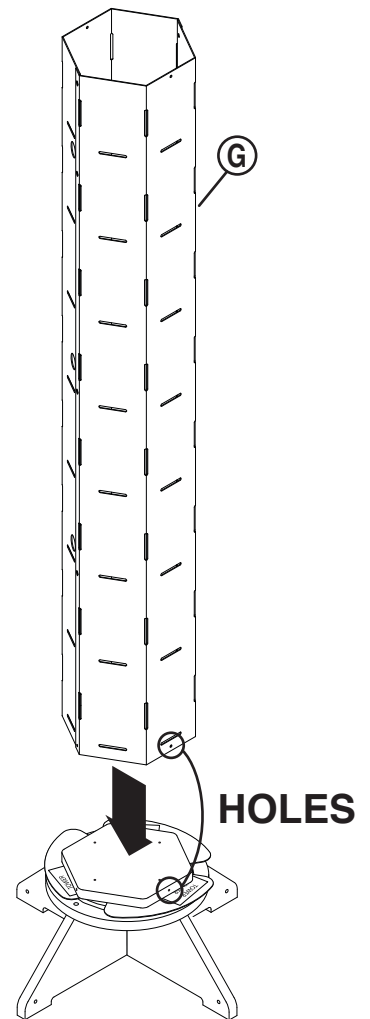

- 11** Secure **Tower Panel Assembly (H)** to Base Assembly at middle holes of Tower Panel Assembly. Attach Tower Panels to Spinner Plate edge with (2) **Trushead Screws (B)**. **DO NOT** tighten completely!

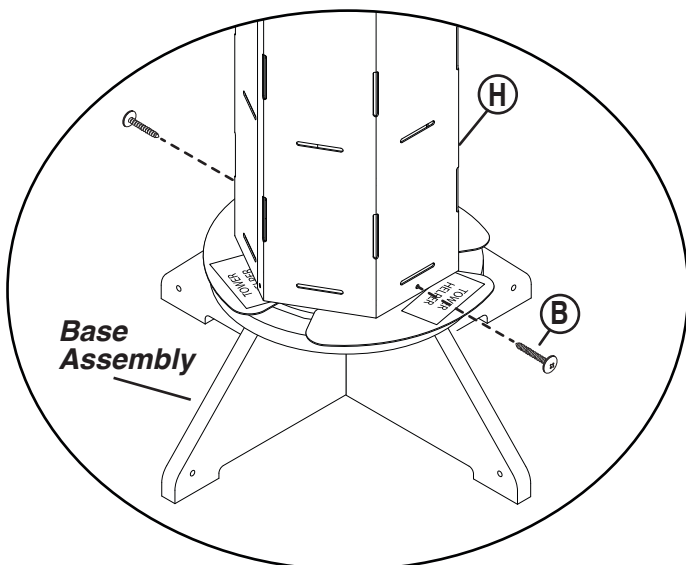

- 12** Continue to secure **Tower Panel Assembly (H)** to Base Assembly at corner holes of Tower Panel Assembly. Attach panels to Spinner Plate edge with (2) **Trushead Screws (B)**. Tighten all (4) securely.

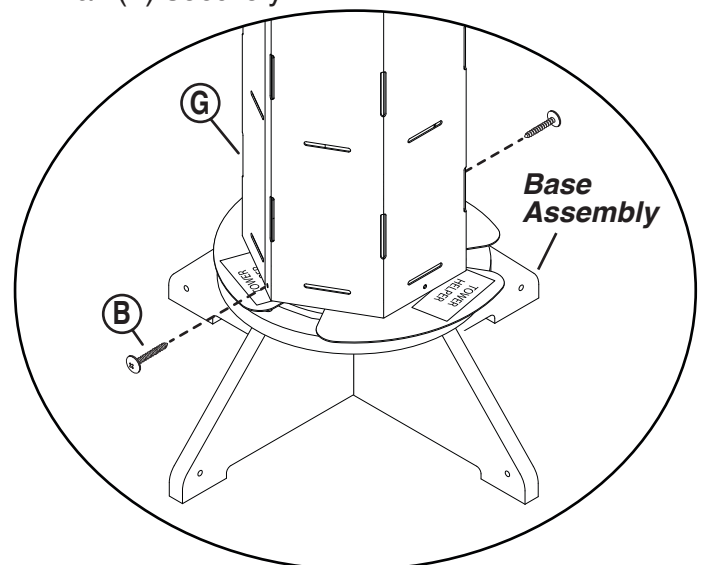

ASSEMBLY

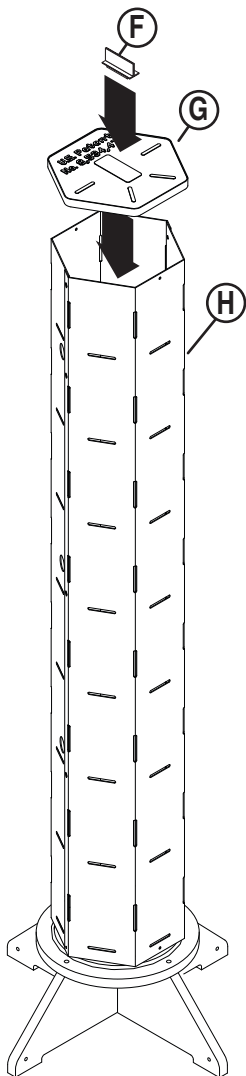

- 14** Peel masking off **Header Clip (F)** and secure to the center of the **Top Cap (G)**.

Lower **Top Cap (G)** on to the top of the **Tower Panel Assembly (H)**.

- 15** Attach **Racks (M)** by hooking the tabs into the vertical slots in the **Tower Panel Assembly (H)**.

Lock bottom tongue of **Racks (M)** into the horizontal slots on the **Tower Panel Assembly (H)**.

Each Vertical Slot holds two **Racks (M)** side by side.

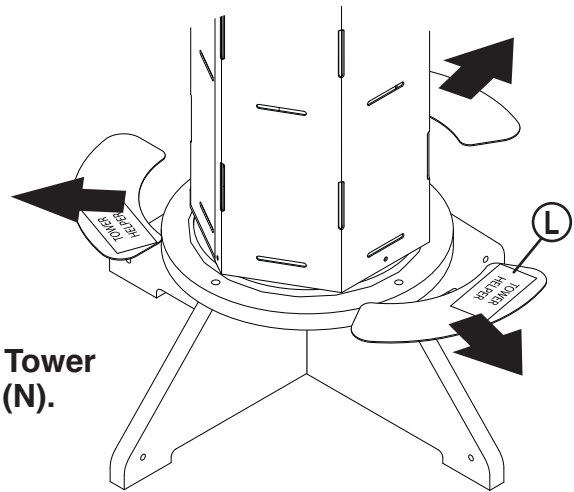

- 13** Remove **Tower Helpers (N)**.

